

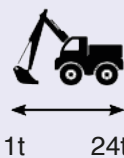

K - MIX

MIXING BUCKET



1t 24t

1

WARRANTY

New



- Manufactured using anti-wear material
- Chain drive motor
- Automatic spring tensioners fitted on the chain.
- Rotation with roller bearings
- Shaft with grooved profile (Ø50/60mm)
- External grease point
- Hydraulic control of outlet opening.

A CONCRETE SOLUTION !

Designed specifically for concrete production with mini-excavators and backhoes.

The technical solutions **offer maximum efficiency and longevity.**

They are equipped with a solenoid valve with electric controls and a push-button for the hydraulic opening of the outlet, flush-faced quick-connect couplers and a corrugated discharge pipe.

TECHNICAL FEATURES

Hydraulic motor which does not require a safety valve.

Chain drive (>2 t).

Hardox mixing helix.

Bucket of superior thickness, Hardox blade.

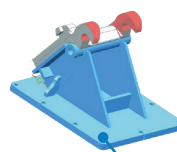

Bolted quickconnect plate.

Bolted protection grille.

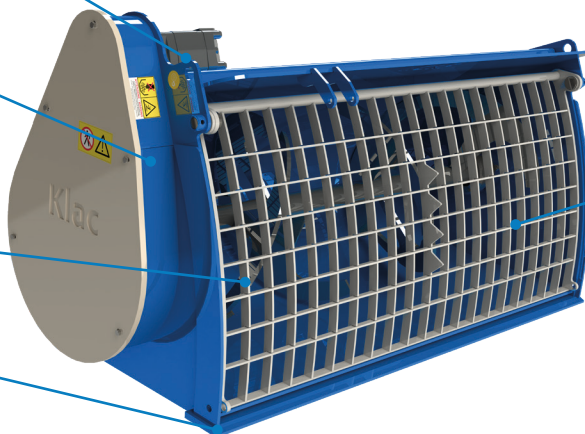



FOCUS ON Discharge



The bucket is fitted with two hooks connected to the sliding opening allowing the direction of the concrete flow to be controlled.

The pipe has a handle at the end to aid handling.

The pipe is 1.50 m long with an internal reinforcing spiral structure.



SAFETY QUESTION

The bolted front grille and the grille on the slide (discharge pipe) protect the operator when the bucket is being used.



The bucket can be mounted in "normal" mode or "reverse mounted" to facilitate the operator's work.



Operation



The machine loads sand into the bucket as normal.

When water and cement are added, the mixing screw produces concrete which is pushed towards the centre of the bucket ready to be discharged.

Simple, efficient and robust with spare parts reduced to a minimum.

INAVILABLE WITH



KLAC SYSTEM



KLAC +



ALTERNATIK

THE RANGE K - MIX mixing bucket

	Weight	Width	Capacity	Total weight	Oil flow rate	Max pressure
	kg	mm	litres	kg	L / min	bar
Model D / 1 (Mxs of 2 to 3,5t)	180* 250**	1 000 1 200	100 160	417 630	60 60	175 175
Model E / 2 (Mxs of 3 to 5t)	330	1 420	200	810	60	175
Model F / 3 (Mxs of 6 to 9t)	400	1 420	250	1 048	75	175
Model G (Mxs of 9 to 12t)	420	1 600	350	1 274	75	175
Model H (Mxs of 12 to 17t)	440	1 600	450	1 565	75	175
Model I (Mxs of 17 to 24t)	650	1 950	600	2 100	125	210

* For 2 to 2.8 ton machines.

** For 3 to 3.5 ton machines.



Klac industrie

Klac industrie S.A.
288, rue des Saules
Z.A Orléans Sologne
Saint-Cyr-En-Val
45075 Orléans
Cedex 2 France

Tél. (33) 2 38 49 82 82
Fax (33) 2 38 49 82 83

contact@klac-industrie.com

www.klac-industrie.com